



LIFESTYLE

PROSPERITY

AUTHENTICITY



The MOST SIGNIFICANT
ADDRESS of your DREAMS



Shiv Valley
Neemgaon
Govardhan
Mathura

Welcome's

a world of Exclusive Spirituality
awaits you





The name you refer as
HAPPINESS.....



Valiant Real Estate Pvt. Ltd. formed in the year 2018, as per Companies Act. 2013. Valiant group is growing day by day in the real state sector of Vrindavan, U.P. We are engaged in the commercial and residential plotting services. We are one of the reliable groups to provide the best and beneficial products to our customers. Valiant group is a leading real estate development group whose working process depends on Client satisfaction, Timely Delivery, qualitative production.

Valiant group was incepted with the solitary purpose of providing professional and honest services to its valuable customers. The customers can count on us for all property related requirement. We are here to fulfil all the big and small demands of our customers. We have already delivered many projects which were highly appreciated.

Transforming Dreams into reality has been the priority of Valiant Group, ever since its establishment. The group is diversified infrastructure conglomerate with business interests in plotting and real estate.

- Our teams are working great to provide best and affordable properties in Vrindavan, U.P.
- We ultimately focus to provide the services to our customers which are beneficial to them in all possible ways, because we know that the we will grow only if the people associated with the group grow.
- To be the best real estate company renowned for transparency, trust, quality, commitment and prudent business policies.
- We as a company totally believes in customer demands and whatever they want, we do we make and we establish.

- To be the only name in the market where people know us by our loyalty and gratitude.
- To become a trustworthy real estate company
- To focus on growth.
- To ensure the customer satisfaction and customerr elationship.
- To be a leading real estate company in the market.

Our team are continuously working to provide the best services to our clients. We mainly focus on the customer needs and their guidelines. We do our best so that our customer can live their dream of owning a dream house. Our team are here to provide the ultimate solution to client's specific concerns.

Mr. Ashok Sharma is the most important pillar of our company. Being a director of the valiant group, He is responsible for many aspects of the business including strategy for business development, fund raising etc. with 20 years of experience, he is managing all the financial and plotting activities. He has done many real estate business on his own.

Mr. Sagar Sharma is the emerging face of this company. Being a founder and director of the company, he is responsible for all the marketing and working of the company. He is a multi-tasking personality with great learning and smartworking attitude. He is a bachelor of Commerce.

Miss. Parul Sharma is a bachelor of technology. She focuses on various technical work and plays a very important role for the growth of this company.

Your Dream | Your House | Our Hard work

PROSPERITY | LIFESTYLE | AUTHENTICITY

the **PROJECT** **HIGHLIGHTS**

The township contains Shiv Mandir in approx 20,000 Sq. Yards
Shiv Tapovan Park in approx 25000 Sq. Yards
800+ Residential Plots, 25+ Farm Houses,
Luxurious Residences (Ground + 2 Floor) & Penthouses
Swimming Pool for Children & Adults separately
Multi Utility Shopping Arcade, Hotel, Petrol Pump
Space for other Commercial Activities, Police Chowki,
Club House, Park for Large Gathering, Multipurpose Activity Hall
Dhyaan-Yog space in the Basement of Shivalay
and Shiv Gram (Classical Stay Homes)

Nestled in the most sought-after localities of Govardhan is a place brimming with privileges like never before. Shiv Valley where you can be one with nature while enjoying modern amenities in a spacious living environment. One-of-its-kind gated retreat, it offers high \ levels of security and exclusivity, to ensure stress and strains stay out of the gates. It is indeed a heavenly abode of happiness, bringing to life all those little extras that make everyday living a sheer joy.

All you have to do is bid farewell to the ordinary mundane life and embrace your new-found joy from a distinctive range of customised spacious homes as per requirement. Simply put, Shiv Valley is the exquisite way of life you'd like to be known for !

Located on 4 Lane Highway connected with Chatta, Vrindavan, Mathura, Alwar & Deeg. Nearby Giriraj Ji Parikarma Marg, Daan Ghati Mandir, Kusum Sarover, Radha Kund, Govardhan, ISKCON School, Hospital & Gaushala. Barsana, Nandgaon, Prem Mandir and many religious places within the radii of 20 Kms.

Enter in a heaven that combines the
best of nature and flawless planning



Residences at Shiv Valley offer a sophisticated approach to design that places emphasis on location and views. Complementing the breathtaking vista, are just exclusive homes- contemporary in design, yet open to the natural splendour surrounding them.

Infinite PLEASURE

KIDS
PLAY ZONE

PLAYFUL world in
the lap of NATURE



HAPPY
Moment
Invites You

WATER PARK & SWIMMING POOL



an **AERIAL**
BEAUTY that
will render you
SPEECHLESS

By having long walks and jogging, you gain better fitness benefits and regularly maintain your health. The unique unfamiliar vegetation greets you to create a bond between nature and yourself, unsolicited so far.

Shiv Valley loads you with world class amenities. It takes care of all basic necessities of living tension-free in the Shiv Valley. Alongwith that, power and water back-up and 24 hour hi-tech security. Shiv Valley happens to be the safest. Plus the resort and features within complex help rejuvenate you to the maximum. There is lot to explore for you. Shiv Valley also offers a little bit of excitement and adventure as you start looking around.

And when it's time for party, there are dedicated lawns clearly demarcated. Delectable cuisines and the ambience are as inviting for you as the starlit skies above. Further, the warmth and the hospitality this place offers, makes Shiv Valley absolutely unique and worth a visit.

Special
Arrangement
for Large
Gatherings on
Multi Occasions



Celebrate the **FESTIVALS** of Life

Incredible GOVARDHAN

Come and make your
life **BLESSED** in
this **HOLY LAND**
of Lord Krishna



Mathura is the abode of Lord Krishna and it has a great religious sanctity among the Hindus. It also has one of the oldest historical records. Even Mathura is mentioned in the epic Ramayan. It is on record that Mathura was one of the capitals of Kushan King Kanishka

Just an hour's drive from Agra, on the banks of the river Yamuna, is situated the birthplace of Lord Krishna. The entire land is dotted with magnificent temples, dedicated to various aspects of his life. The twin cities of Mathura and Vrindavan, where he was born and where he grew up, still resound to the sound of his laughter, antics and his magical flute.

Some of the famous temples are Govind Dev Temple, Rangaji Temple, Dwarikadhish Temple, Bankey Bihari Temple and the ISKCON Temple.

Gokul, Barsana and Govardhan are the other township associated with the legend of Lord Krishna. Gokul is the hideout where Lord Krishna was secretly brought up-away from the eyes of his maternal uncle Kansa. His consort Radha belonged to Barsana, where the unique Holi festival Lathamar Holi is celebrated with great gusto. At Daan Ghati Mandir, Govardhan, Krishna raised a mighty mountain on his little finger to protect the locals from the wrath of rain-god Indra.

In and around this heart of Braj Bhumi are spots and symbols that may immerse your trip in spiritualism. The twin cities personify the legend of Lord Krishna, with folklore, cultural traditions and even day-to-day life are imbued with a divine presence.

Amidst the mesmerizing temples, gardens, music, art and dances the legend of Lord Krishna comes alive in all its colour and glory – every day. The Charkula dance, Raasleela and the lilting folk music recreate the aura of devotion and love.

The historical treasures at the Mathura Museum are a window to a glorious past that will keep you asking for more.



Yoga and Meditation Center for Happiness, Peace and Prosperity

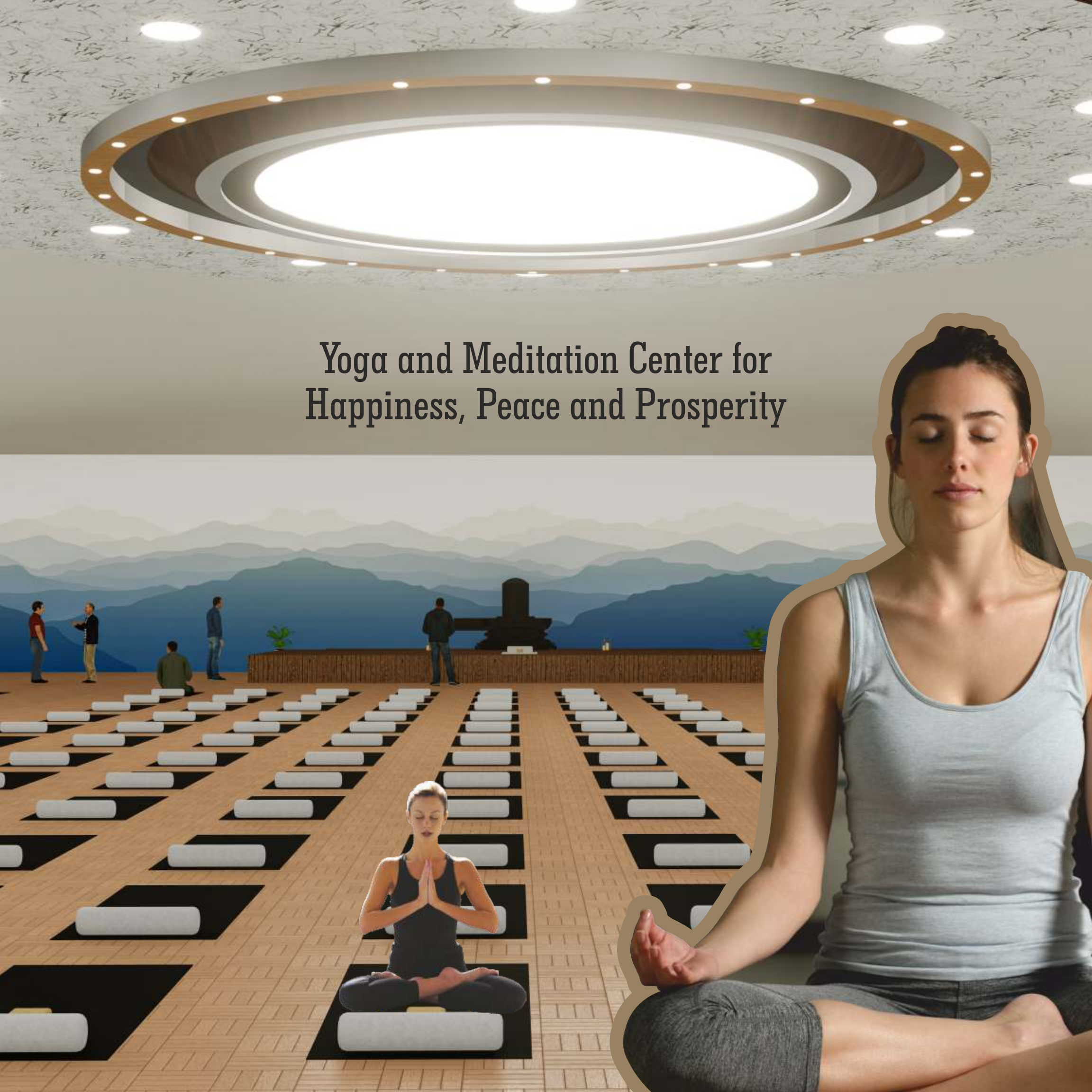

Features & Specialities

Keeping the best of amenities as part of the project Shiv Valley, in its peace and serenity ensures the residents an impeccable maintenance with stress on cleanliness with an all round multi-tier security system.

PROJECT FEATURES

- Park and Open Spaces as per Govt. Norms.
- Convenient Plots Sizes 50-500 Sq. Yds.
- Farm Houses Starts from 500 Sq. Yds.
- Commercial Space, Flats & Penthouse
- Development like International Township
- Well connected with Local Transport
- Commercial Shopping Complex
- Vaastu Friendly Layout Design
- Easy Monthly Installments
- Township with Gated Entry
- Water Supply, Electricity & Roads
- 24 x 7 Security
- School & Temples

UNMATCHED LIFE STYLE SERVICES

Availability for :

- Fully Wi-Fi friendly connectivity for each flat.
- Telephone port installed in every room.
- Intercom facility connecting each flat.
- DTH Connection for each flat.
- 100% lush green landscaped area.
- Ultra Modern Club House
- Effluent Treatment Plant.
- Common services
- 70% Open Area

INTERIOR

- POP finish on walls & ceiling with cornices.
- Acrylic plastic paint on walls & ceiling.
- Polish/paint on doors & windows.

COMMUNITY LIVING

- Sun face & Minimum two-side open Flat
- Safe & Secure parking for residents
- Ample parking space for residents & visitors
- Community premises guarded with boundary

SECURITY

- 24 hrs. live CCTV.
- Fire fighting system.
- 24 hrs. security managed by professionals staff.



Relish
the **HIGH LIFE**

multi utility SHOPPING ARCADE

Seek at Home your
CHOICEST BRANDS

Designed strategically, comprising retail outlets for latest brands of your choice within the same vicinity saving you to wander in outside markets. The very exclusive decoration of brands invites ethical beauty in minds of the onlookers. Once here, even window shopping cannot resist to be real shopping due to attractive, reasonably-priced and genuine brands of articles decoratively placed in the outlets.

- | Retail Outlets
- | Food Plaza
- | Multi-utility Stores
- | ATM / Bank

latest spectacular
trends in vogue



a PLAYFUL World in the LAP of NATURE

exclusive CLUB HOUSE

A pollution free excursion joint is the Clubhouse. On one hand the sports enthusiasts and leisure seekers can chase their interests with equal passion and on the other hand there's the yoga room for those seeking a meditative relief and spiritual soul upliftment. The children too are part of the club house with various games and playful activities. The steam room welcomes all for their physical freshness.

- Ultra Modern Gymnasium
- Swimming Pool with Change Room
- Separate Kid's Pool
- Aerobic & Yoga Hall
- Steam Bath Facility
- Indoor Games Area
- Multi Activity Area
- Outdoor Games Area
- Jogging Track
- Mini Library

feel the warmth of WATER to REJUVENATE

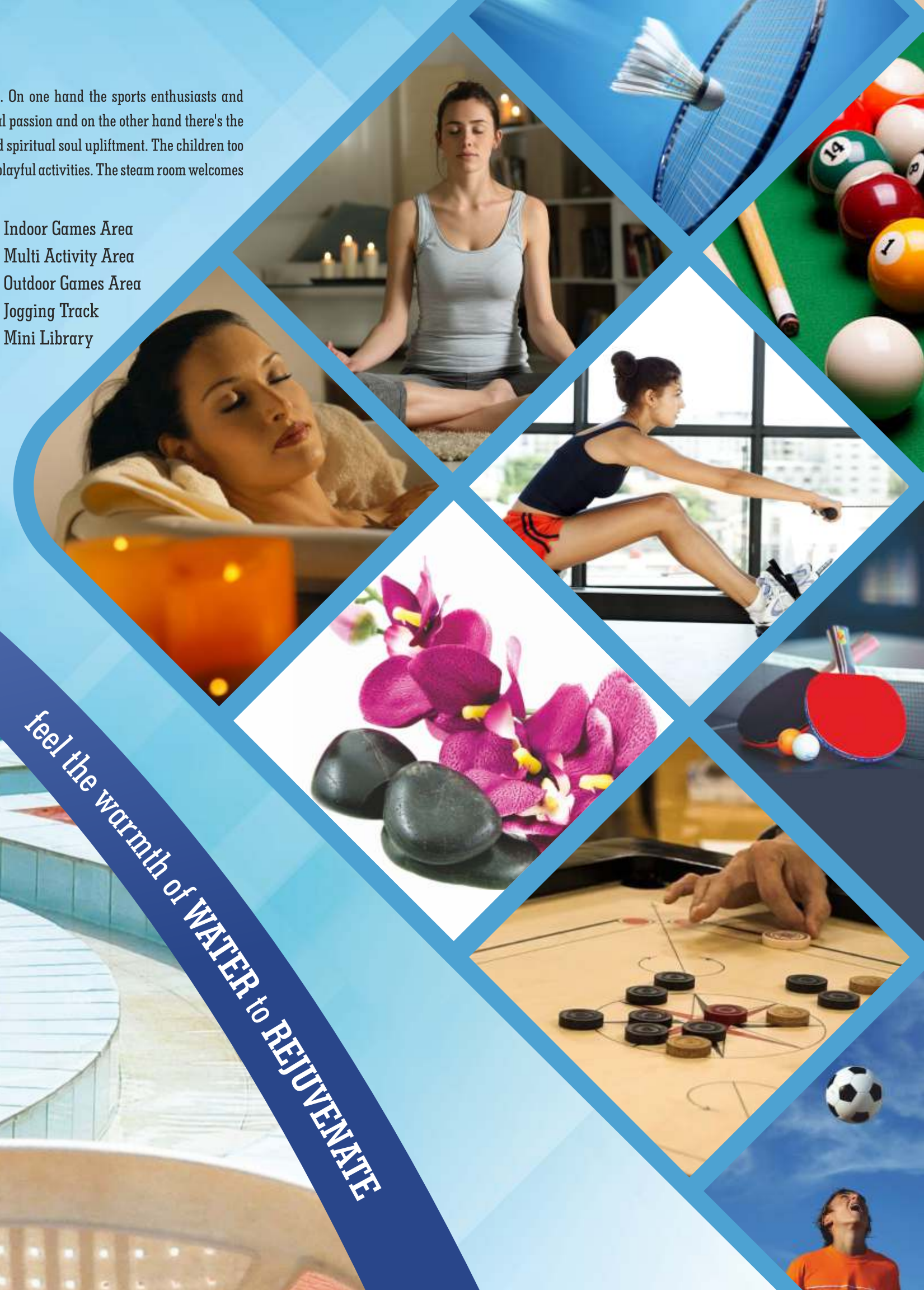

an invitation to **COZY MOMENTS**

Stylish & Cozy FARMHOUSE

Shiv Valley loads you with world class amenities. It takes care of all basic necessities of living tension-free in the Shiv Valley. Alongwith that, power and water back-up and 24 hour hi-tech security. Shiv Valley happens to be the safest. Plus the resort and features within complex help rejuvenate you to the maximum. There is lot to explore for you. Shiv Valley also offers a little bit of excitement and adventure as you start looking around.



BLESSED Surroundings

Shiva Valley is surrounded by religious places where Lord Krishna used to perform his pastimes.

1. Shri Radha Raman Ji Temple
2. Daan Ghati Mandir (Govardhan Parvat)
3. Kirti Mandir, Barsana
4. Shri Dwarkadhish Temple, Mathura
5. Shri Nandbaba Temple, Nandgaon
6. Prem Mandir, Vrindavan
7. Holi Festival at Shri Bankey Bihari Temple
8. Shri Govind Dev Ji Temple
9. Lathmaar Holi at Barsana
10. Rangnaath Ji Temple, Mathura

Live in SPIRITUAL
ATMOSPHERE

Invitation
to see the CULTURE
and HERITAGE of God



Location Map Not to Scale

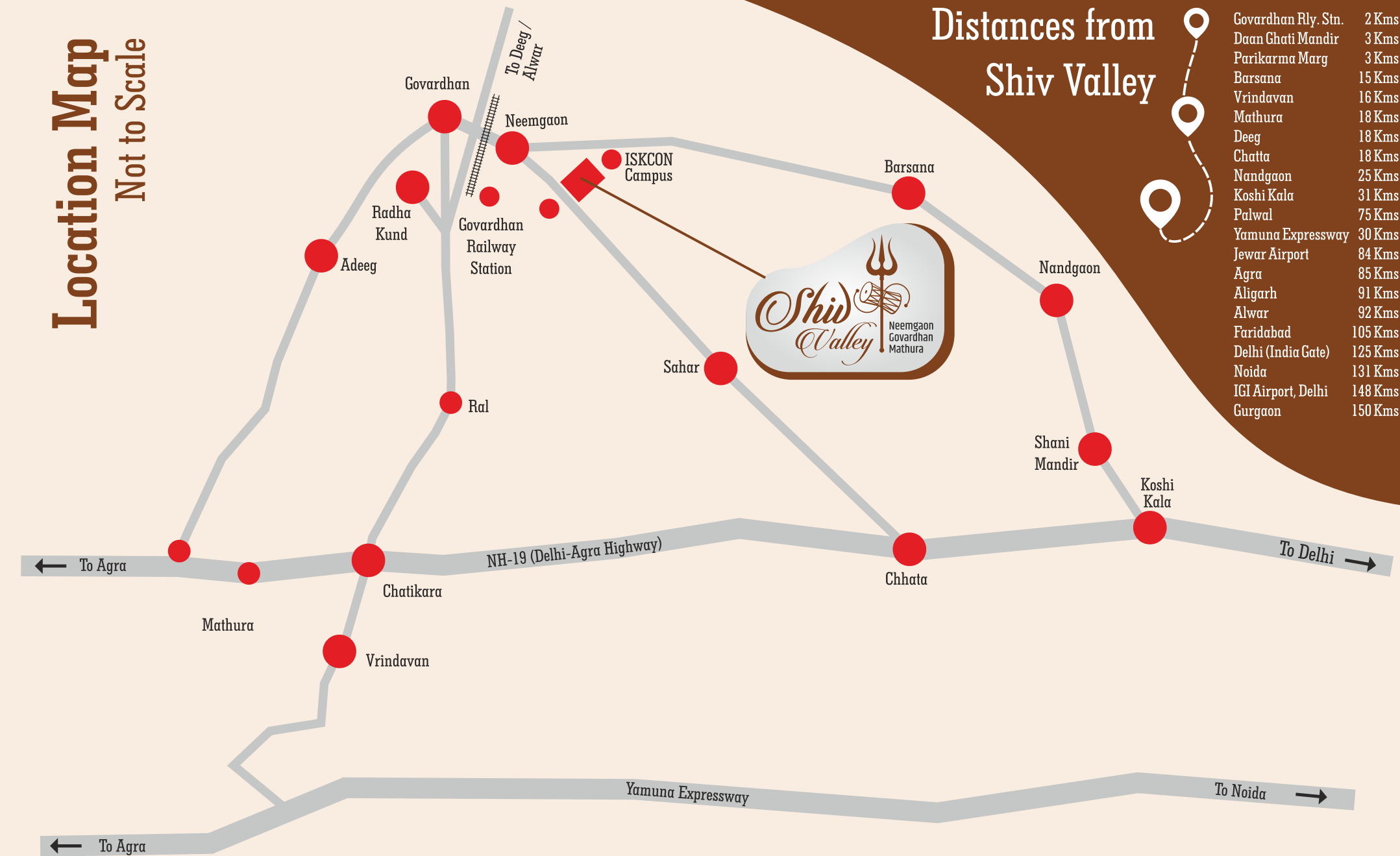

AWAY from the WORLD of POLLUTION

Environmentally Healthy &
Serene surroundings



The Perfect
**INVESTMENT
DESTINATION**
for Business & Personal

Authorised Channel Partner:

Developer & Promoter:



VALIANT
REAL ESTATE PVT LTD
रिश्ता विश्वास का

VALIANT REAL ESTATE PVT. LTD.

Corporate Office : B-60, 1st Floor, Sector-2, Noida-201301 (U.P.)

E-mail: info@valiantrealestate.co.in

Web.: www.valiantrealestate.co.in

"This brochure is conceptual and not a legal offer. No claim is admissible on details herein."